

Euro Rod

Quickly adapt to changing concrete forming conditions by keeping a supply on hand



Euro Rod is a hot-rolled, high strength, threaded steel bar for concrete forming.

Euro Rod			
Part No.	Description	SWL* (lbs)	Weight (lbs/ea)
ER15MM12	15mm Rod x12'	21,300	12.0
ER15MM20	15mm Rod x19'-6"	21,300	19.5
ER20MM12	20mm Rod x12'	38,800	19.2
ER20MM20	20mm Rod x19'-6"	38,800	31.2

* Safe Working Load (SWL) based on 2:1 safety factor.

Euro Rod is also available cut-to-size. Contact a CCS representative for pricing and availability.



Euro Nut



Euro Wing Nut

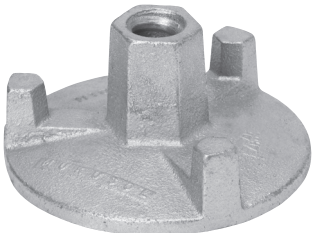

Euro Wing Nut Plate

Euro Nuts	
Part No.	Description
ER15SN	15mm Nut
EWN58	15mm Wing Nut
EWN58P	15mm Wing Nut Plate
EWN58SP	15mm Wing Nut wSwivel Plate
ER20SN	20mm Nut
EWN78	20mm Wing Nut
EWN78P	20mm Wing Nut Plate
EWN78SP	20mm Wing Nut wSwivel Plate